

Rear Brakes

Repair Instructions

Rear Brake Components

BENE31J14306001

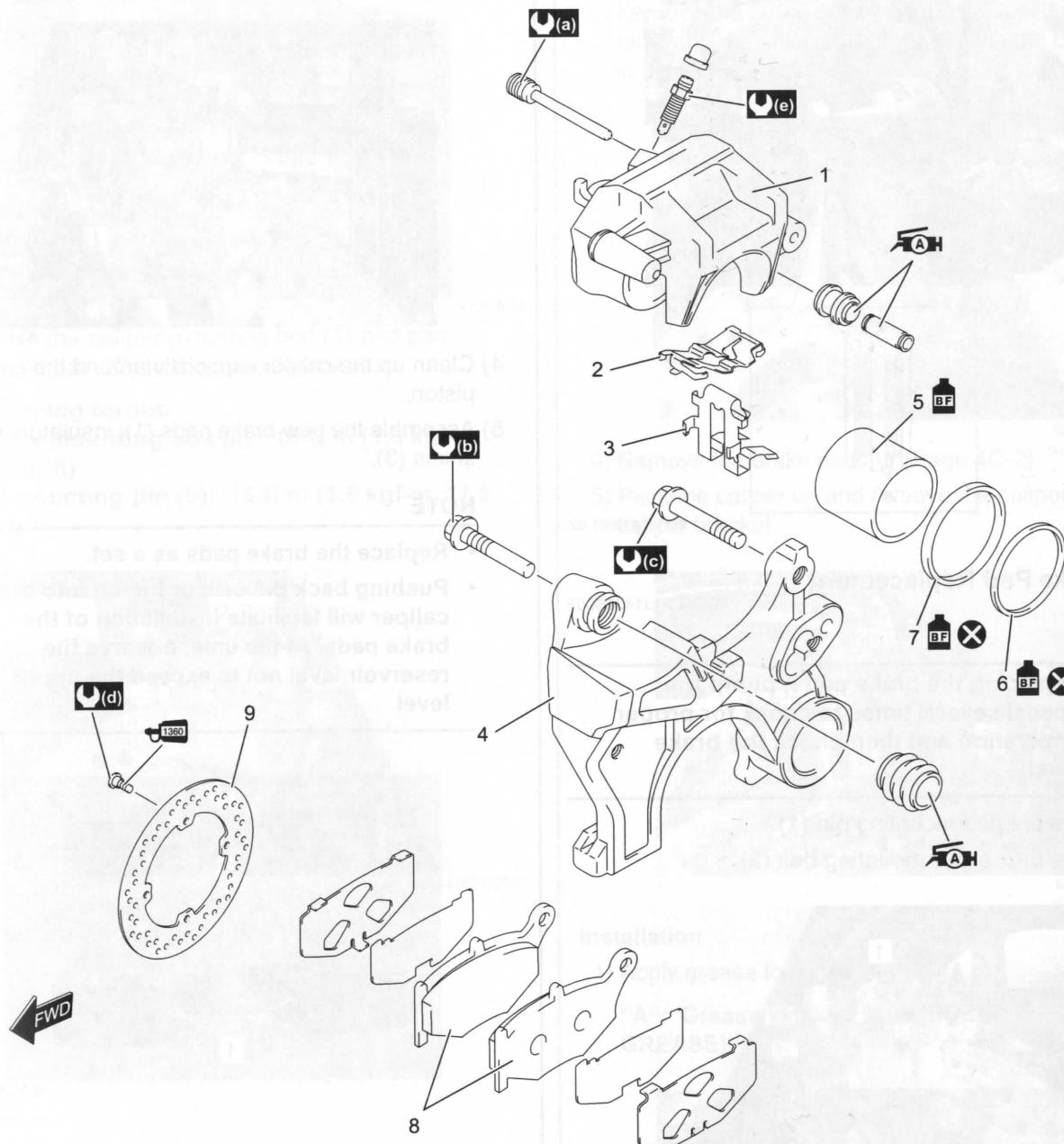

IE31J1430030-03

1. Rear brake caliper	7. Piston seal	(d) : 23 N·m (2.3 kgf-m, 17.0 lbf-ft)
2. Brake pad spring	8. Brake pad	(e) : 7.5 N·m (0.75 kgf-m, 5.5 lbf-ft)
3. Retainer	9. Rear brake disc	: Apply silicone grease.
4. Caliper bracket	(a) : 16 N·m (1.6 kgf-m, 11.5 lbf-ft)	: Apply thread lock to the thread part.
5. Piston	(b) : 33 N·m (3.3 kgf-m, 24.0 lbf-ft)	: Apply brake fluid.
6. Dust seal	(c) : 18 N·m (1.8 kgf-m, 13.0 lbf-ft)	: Do not reuse.